

Series 730

SERIES 730



Design Features

This very rugged size 25 encoder has been designed to suit a wide variety of industrial applications, and may be specified in various output options, from 0001 to 1600 PPR, as per Table C on pages 48 and 49. Encoder 730/1 is a single channel, 730/2 is quadrature and 730/3 is single + marker. **A stainless steel version is available at a modest surcharge. This version is designed for hostile environments or food applications. It is protected to IP66, and is configured with 2 metres of flying lead. Please call the sales office for details.**

Specifications

Input Voltage range	5/24V (see output circuits)	Starting torque	0.02 Nm (0.02 with seal)
Regulation, for 5V operation	5%, with 2% maximum ripple	Radial loading	80 N operating
Current consumption	50 to 100mA typical	Axial loading	60 N operating
Output circuits	See Ordering Information	Moment of inertia	320 g/cm
Frequency response	50 KHz standard	Acceleration	10 ⁵ radians/sec ²
Symmetry	180° electrical ±5% (9°e)	Weight	0.45 kg
Quadrature Phasing	90° electrical ±10% (9°e)	Housing	Aluminum w/protective finish
Minimum edge separation	72° electrical	Mounting	Servo flange or square flange
Reference marker pulse	Gated (A • Z = F) other options avail.	Operating temperature	-10°C to +70°C
Rise time	Less than 1 microsecond	Storage temperature	-35°C to +85°C
Accuracy (cycle to cycle)	±0.017° or 1 Arc/Min	Humidity	98% RHNC
LED life	100,000 hrs typical	Vibration	10 G's @ 58 to 500 Hz
Pulses per revolution	See Ordering Information	Shock	50 G's for 11 mSec
Max shaft speed	6,000 rpm continuous	Protection	IP50 standard IP64 w/seal (S30) IP66 w/seal (S36)
Shaft sizes and types	See Ordering Information		
Shaft tolerance	g6, sliding fit for H7		
Bearings	Double Sealed, ABEC 3		

Ordering Information

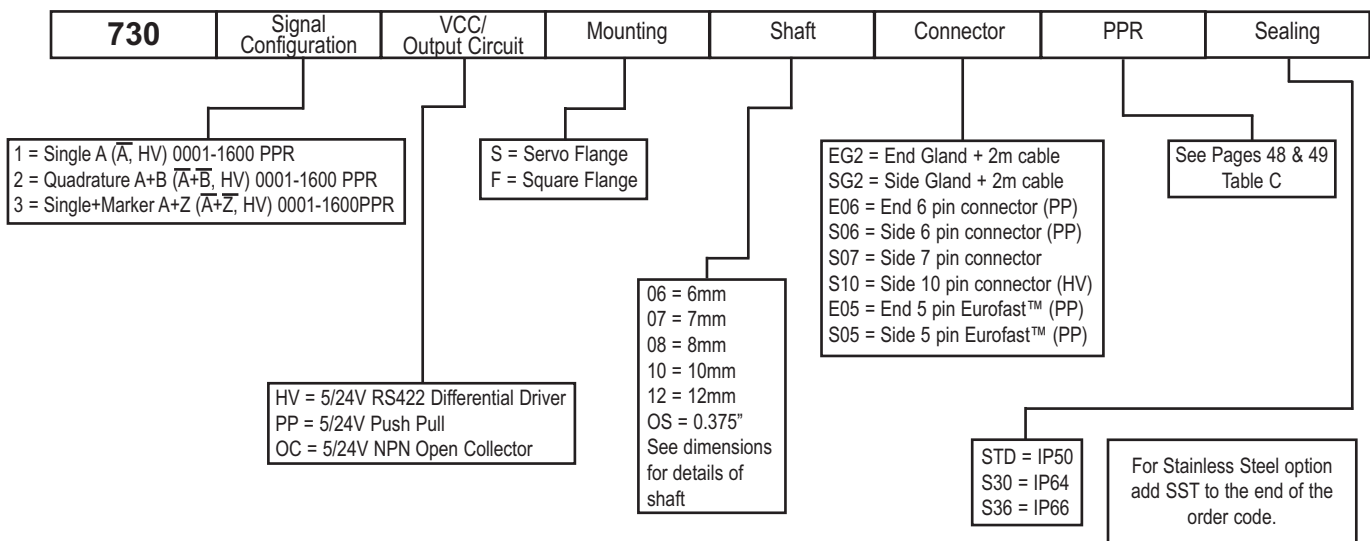



Output Circuits

HV
Universal
Differential
Line Driver

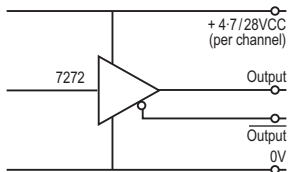

PP
Push-Pull

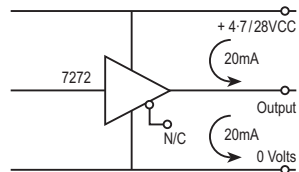

OC
NPN Open
Collector

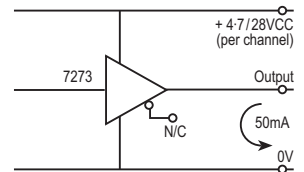

Dimensions

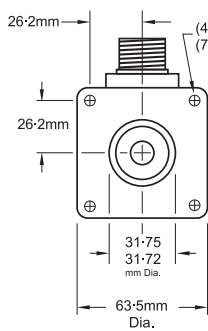

Flange Mount

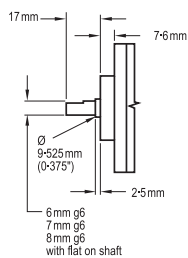

6, 7 and 8mm Shafts

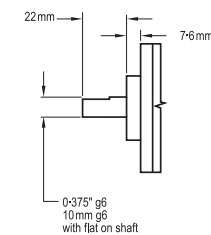
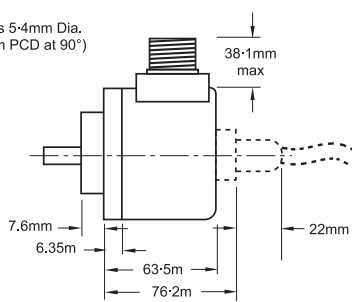

0-375" and 10mm Shafts

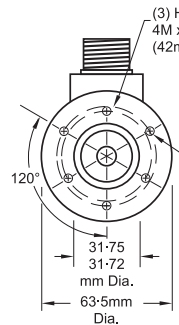

Servo Mount

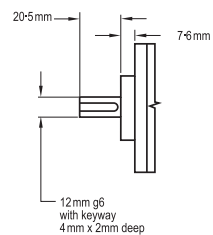

12mm Shaft

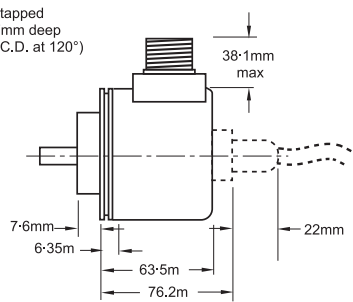

(3) Holes tapped
10-32 x 12.7mm deep
(47.6mm P.C.D. at 120°)

