

For use on LMI Series B and C
chemical metering pumps.

CAUTION

When pumping chemicals make certain that all tubing is securely attached to the fittings. It is recommended that tubing or pipe lines be shielded to prevent possible injury in case of rupture or accidental damage. Always wear protective clothing when working on or near chemical metering pumps.

NUMBER 73 LIQUID HANDLING ASSEMBLY

A. INSTALLING INJECTION CHECK VALVE

1. The injection check valve should always be installed as close as possible to the point of chemical injection, at the very end of the tubing run.
2. Purpose of injection check valve is to prevent backflow from *treated line*.
3. A 1/2" NPT female connection or tee will accept the injection check valve.
4. In order to insure correct seating of the ball inside the check valve, the injection check valve should be installed upwards.

B. CONNECTING DISCHARGE TUBING

Note: Cut tubing to length needed for discharge line.

1. Discharge tubing is relatively stiff translucent tubing.
2. Route tubing from injection check valve to chemical metering pump making sure it does not touch hot surfaces, sharp surfaces, or is bent so sharply that it kinks.
3. Slide small end of coupling nut onto tubing.
4. Push tubing over tapered nozzle of pump head so that tubing flares out and reaches the shoulder. (If tubing is stiff from cold, dip end in hot water).
5. Slide down the coupling nut until threads are engaged. Tighten by hand until tubing is held securely in place.

CAUTION

Excessive force will crack or distort fitting.
DO NOT USE PIPE WRENCH.

6. Follow the same procedure for connecting tubing to injection valve.

C. CONNECTING SUCTION TUBING

1. Suction tubing is soft transparent tubing.
2. Cut suction tubing to length necessary between suction valve of chemical metering pump and foot valve. Foot valve should just sit at the bottom of chemical container. Maximum recommended vertical suction lift is 5 ft. (1.5m).

3. Follow same procedure (see B) in connecting suction tubing to suction valve and foot valve.
4. If a suction tube straightener is desired, one may be fabricated from a 3 ft. (1m) piece of 1/4" Schedule 80 PVC pipe.
5. Dip end of PVC pipe in hot water for at least 1 minute.
6. Push pipe over small end of coupling nut.

D. CONNECTING FLUSH VALVE TUBING

Note: Flush valve tubing is relatively stiff translucent tubing similar to discharge tubing.

1. Cut tubing to required length, and install one end to flush check valve at the side of the pump head.
2. Install a 1/4" NPT shut off valve on a fresh water line whose pressure is at least 5 psi (0.35 Kg/cm²) greater than pressure at point of chemical injection.
3. At the outlet of this shut off valve, screw in Part No. 10482 connector. Use Teflon tape on pipe threads. Install other end of flush valve tubing and hand tighten coupling nuts.

E. PRIMING

1. Open shut off valve on fresh water line to allow water to enter and fill pump head. If pump is equipped with automatic flush it would be necessary to push toggle switch on pump control panel towards "FLUSH" position to open solenoid valve. When pump head is filled with water, push toggle switch to "AUTO". Set "FLUSH SEC" to desired flush duration every five minutes.
2. Metering pumps without Automatic Flush feature should now be started and allowed to operate normally. Close shut off valve on fresh water line as soon as pump is primed.

CAUTION

To prevent syphoning, injection check valve must be located where there is positive pressure or elevation higher than solution level.



LIQUID METRONICS INCORPORATED

3 JONES ROAD, WALTHAM, MASS. 02154 USA
(617) 891-0690 TTY: 02-2478

Specifications subject to change without notice.
Printed in U.S.A.

1061F
2C1178
replaces

PARTS LIST NO. 73 LIQUID HANDLING ASSEMBLY

Key No.	Part No.	Description	Quantity
1	10296	Injector Fitting w/Hypalon Flapper	1
3	10338*	Ball, Ceramic	5
4	10107*	Seal Ring, Hypalon	5
5	10492	Valve Seat, gray PVC	2
6	10211	Coupling Nut, gray PVC	4
7	10142	Tubing, Polyethylene 1/2" OD x 3/8" ID	10 ft.
8	10493	Valve Housing, gray PVC	2
9	10104-1	Head, 1.8 SI Plexiglas	1
10	10105*	Liquifram, 1.8 SI Hypalon	1
11	10340	Screw, 10-24 x 3/4" S.S.	4
12	10322	Weight, Ceramic	1
13	10978	Foot Valve Seat, black Polypropylene	1
14	10123	Strainer, white Polypropylene	1
15	10764	Injection Check Valve Assembly	1
16	10512	Discharge Valve Assembly	1
17	10513	Suction Valve Assembly	1
18	10514	Foot Valve Assembly	1
19	10765	Head Assembly, LE 73	1
20	10482	Connector, 1/4" NPT Male	1
21	10141	Tubing, Vinyl, 1/2" OD x 3/8" ID	6 ft.
22	10342	Tubing, Polyethylene, 3/8" OD x 1/4" ID	10 ft.
23	10299	Coupling Nut, gray PVC	1
24	10292	Valve Seat, gray PVC	1

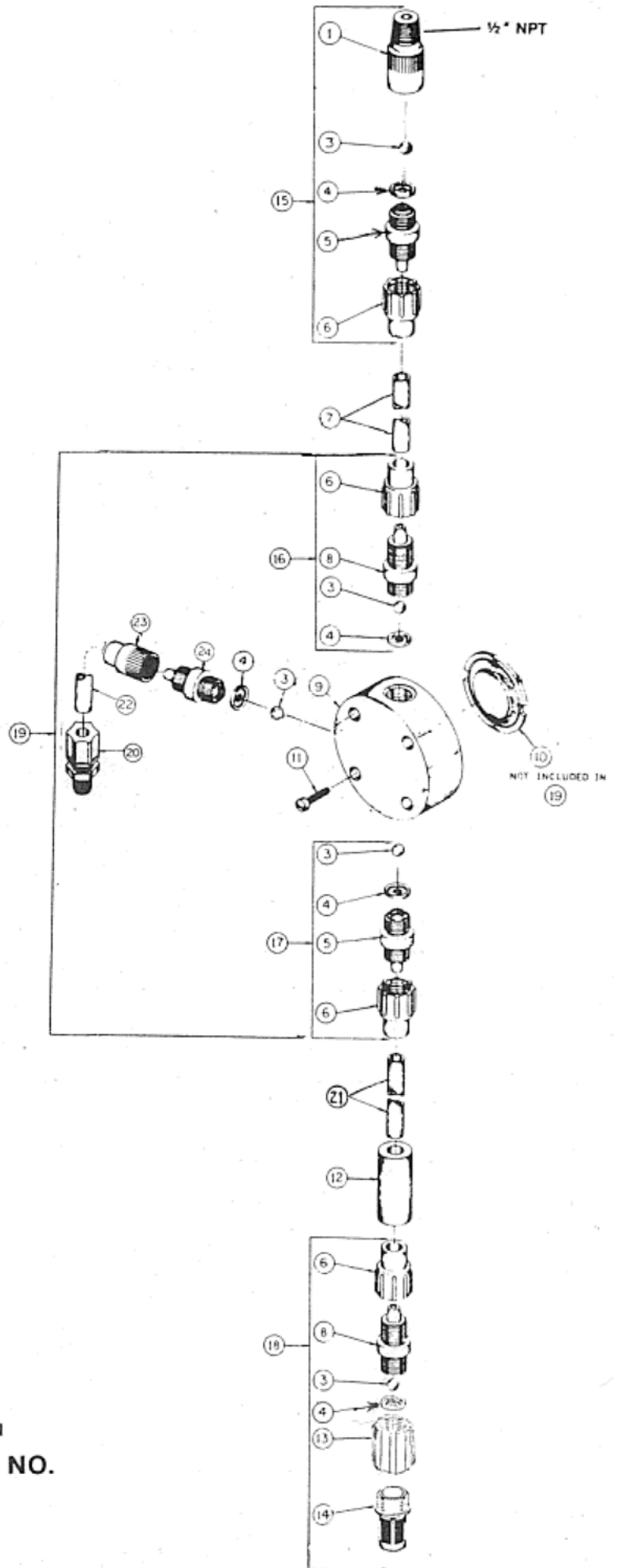

*PARTS INCLUDED IN
SPARE PARTS KIT NO.

SP - 73